

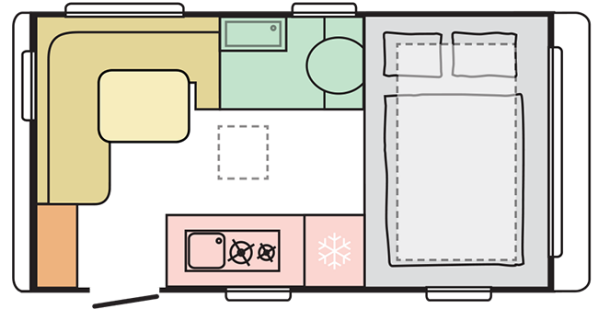

ACTION  
**391 PD**

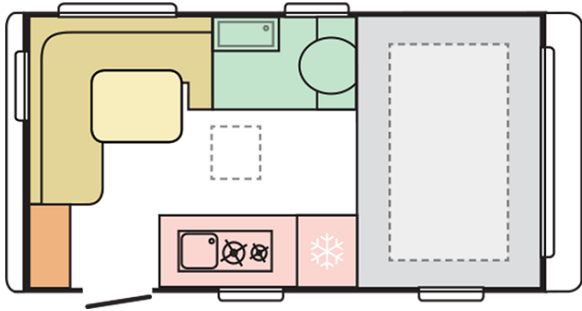

---

## ACTION

### 391 PD

---

Total length including drawbar (mm)

**6104**

Total height (mm)

**2580**

Mass in running order (MRO, kg)

**1005**

Total width (mm)

**2196**

Nr. of berths

**2**

## B. DIMENSIONS AND WEIGHTS

Internal height (mm)	1950
Total height (mm)	2580
Total length including drawbar (mm)	6104
Body length (mm)	4460
Internal length (mm)	4110
Total width (mm)	2196
Internal width (mm)	2080
Awning perimeter dimensions (body/chassis, cm)	782/345
Ex-Works weight ( kg )	920
Mass in running order (MRO, kg)	1005
Maximum technically permissible laden mass (MTPLM, kg)	1300
Floor, wall and roof total thickness (mm)	40/24/23,8
Maximum loading weight (kg)	304
Floor, wall and roof insulation thickness (mm)	29/20/20

## CE. ADRIA VEHICLE INFORMATION

Coupling device AK	150 V AKS
Tyres size	185/65 R14
Tyres service kit	O
Wheel box insulation	X
Standard supporting legs	X
Wheel trims	X

## CE. ADRIA VEHICLE INFORMATION

Drawbar cover	X
Coupling device - stabilizer	X
Spare wheel with holder	O
Steel wheels	X
ADRIA ALU WHEELS	O
Shock absorbers	X
Standard axle	X
Chassis type	AL-KO
Number of axles	1
Mud protection	O

## E. BODY

Front and rear wall lining in thermoformed ABS	X
Entrance door 2-part without window	X
Entrance door 2-part with window	O
Flyscreen whole door	O
Flyscreen - upper part	O
Blackout roller blinds with flyscreen on all windows	X
Opening windows all	X
Adria windows darker	X
Side wall of polyester	X (white or grey)
Roof light Midi Heki 700 x 500 mm	X

## E. BODY

Panoramic widow Action (double)	X
Bodywork of polyester	X
Third break light	X
Double glazed front windscreen	X
Floor insulation Styropor	X
Side wall skirtings in thermoformed ABS	blue
Side wall skirtings in thermoformed ABS green	O (only with white)
Luggage door on right side (light dimensions, cm)	72 x 37
Gas bottle locker	X
Movable entrance step	X
Luggage door on left side (light dimensions, cm)	72 x 37

## F. INTERIOR EQUIPMENT

Number of berths	2
Furniture decor	NOCE COGNAC
Sleeping area, front berths (cm)	204x147
Textile standard	MT02H7 BRUNELLO MINT
Textile optional	MT02I4 BRUNELLO BLACK
Decorative pillows (2 pcs) 60x50cm	O
Decorative cushions 4 pcs.	O
Blanket	O
Bed coverlet	O

## G. KITCHEN EQUIPMENT

Cooker 2 flame with glass cover SMEV	X
Refrigerator	140 L
Sink cover/chopping board	O
Kitchen taps (cold & hot water)	X

## H. BATHROOM EQUIPMENT

Shower curtain	X
Shower tray	X
WC chemical, fixed, passive ventilated	X
Separate shower faucet	X

## I. WATER INSTALLATIONS

Waste water tank (l)	O
Fresh water tank with external inlet (l)	50 L
Boiler Truma Therme 5 L	X
Central waste water outlet	X

## J. ELECTRICITY

Main fit switch	X
Ceiling LED lights	X
Light in luggage compartment	X
USB switch	X
Awning LED light	X
Spot halogen lights	X
Transformer 300 W	X
Preinstallation for charger with battery box	O

## J. ELECTRICITY

Power sockets 230 V	X
Battery charger	O / 17A
TV aerial connector with coaxial cable	X
13-pin socket Jaeger	X
Additional spot lights in sitting area	X

## K. HEATING/AIR CONDITIONING

Gas heating stove Truma S3004	X
Hot-air distribution Trumavent	X
Additional electric heater Truma Ultraheat	O
Preinstallation for additional electric heater Truma Ultraheat - preinstallation	X
Electrical floor heating with transformer	O

## L. GAS

Gas bottle holder	X - on drawbar
Gas bottle compartment 2 x 11 kg	1x 11 kg
Gas regulation valve	X

## M. AUDIO/VIDEO

Bluetooth amplifier	O
Loudspeakers with preinstallation for bluetooth transmitter	X
TV holder	O