

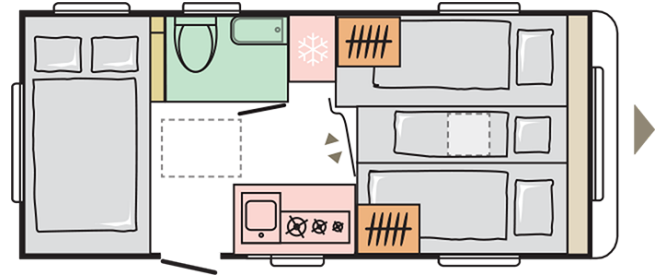

AVIVA  
492 LU

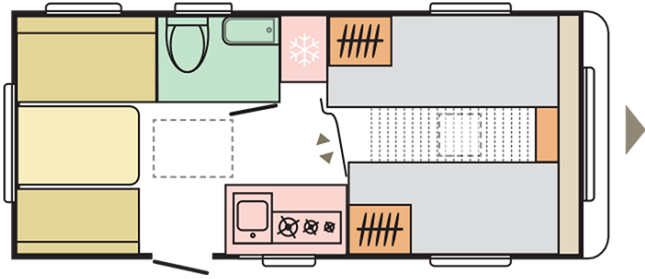

---

## AVIVA

### 492 LU

---

Total length including drawbar (mm)

**6849**

Total height (mm)

**2580**

Mass in running order (MRO, kg)

**1025**

Total width (mm)

**2300**

Nr. of berths

**5**

## B. DIMENSIONS AND WEIGHTS

Internal height (mm)	1950
Total height (mm)	2580
Total length including drawbar (mm)	6849
Body length (mm)	5384
Internal length (mm)	4882
Total width (mm)	2300
Internal width (mm)	2170
Awning perimeter dimensions (body/chassis, cm)	935/515
Flat roof length	3600
Ex-Works weight ( kg )	958
Mass in running order (MRO, kg)	1025
Maximum technically permissible laden mass (MTPLM, kg)	1350
Floor, wall and roof total thickness (mm)	40/22,9/23,8
Maximum loading weight (kg)	307
Floor, wall and roof insulation thickness (mm)	29/20/20

## CE. ADRIA VEHICLE INFORMATION

Coupling device AK	150V AK160
Tyres size	185/65 R14
Tyres service kit	O
Standard supporting legs	X
Wheel trims	O

## CE. ADRIA VEHICLE INFORMATION

Coupling device - stabilizer	O
Spare wheel with holder	O
Steel wheels	X
Shock absorbers	O
Standard axle	X
Chassis type	AL-KO
Number of axles	1
Mud protection	O

## E. BODY

Front and rear wall lining in thermoformed ABS	X
Entrance door 2-part without window	X
Entrance door 2-part with window	O
Flyscreen whole door	O
Flyscreen - upper part	O
Side wall in aluminium	X
Blackout roller blinds with flyscreen on all windows, except bathroom window	X
Opening windows all	X
Adria windows darker	X
Roof light Midi Heki 700 x 500 mm	O
Roof light Mini Heki single glazed, 150cm <sup>2</sup> ventilation	X
Bodywork of polyester	X

## E. BODY

Third break light	X
Double glazed front windscreen	X
Floor insulation Styropor	X
Side wall skirtings in thermoformed ABS	X
Gas bottle locker	X
Movable entrance step	O
Luggage door on left side (light dimensions, cm)	98 x 36

## F. INTERIOR EQUIPMENT

Number of berths	5
Furniture decor	Lidberg Eiche + Lucida white
Sleeping area, front berths (cm)	200x81, 186x81 or 200/186x211
Textile standard	MT02E6 BAHIA
Textile optional	MT02M1 FLORIAN
Textile optional	MT02N6 ROBYN
Textile optional	MT02N7 OLIVIA
Cushions Warm Brownies	O
Cushions Grey planet	O
Cushion Summer vibes	O
Cushions Dream harmony	O
Cushions Mystic garden	O
Cushions Brownies	O

## F. INTERIOR EQUIPMENT

Decorative cushions 4 pcs.	X
Bed coverlet	O
Sleeping area, rear berths (l x w, cm)	211x109
Cupboards Classic	O
Shelves in kitchen	O

## G. KITCHEN EQUIPMENT

3-flame gas cooker with electric ignition, glass cover and stainless steel sink	X
Refrigerator	140 L
Sink cover/chopping board	O
Kitchen taps (cold & hot water)	X
Microwave oven	O
Microwave oven preinstallation	X
Chuck box (outside kitchen)	O

## H. BATHROOM EQUIPMENT

Bathroom taps (washing+showering)	X
Shower curtain	X
Shower tray	X
WC chemical, turnable, passive ventilated	X
Toiletry to go	O

## I. WATER INSTALLATIONS

Waste water tank (l)	O
Fresh water tank with external inlet (l)	50 L
Boiler Truma Therme 5 L	X

## I. WATER INSTALLATIONS

Central waste water outlet	X
----------------------------	---

## J. ELECTRICITY

Main fit switch	X
-----------------	---

Ceiling LED lights	X
--------------------	---

USB switch	X
------------	---

Awning LED light	X
------------------	---

Transformer 300 W	X
-------------------	---

Preinstallation for charger with battery box	O
--	---

Preinstallation for charger with battery box and external multifunctional outlet	O
--	---

Power sockets 230 V	X
---------------------	---

Battery charger	O / 17A
-----------------	---------

TV aerial connector with coaxial cable	X
--	---

13-pin socket Jaeger	X
----------------------	---

Additional spot lights in sitting area	X
--	---

## K. HEATING/AIR CONDITIONING

Gas heating stove Truma S3004	X (only with Truma P )
-------------------------------	------------------------

Hot-air distribution Trumavent	O (only with Truma P )
--------------------------------	------------------------

Additional electric heater Truma Ultraheat	O (only with Truma P )
--	------------------------

Preinstallation for additional electric heater Truma Ultraheat - preinstallation	X (only with Truma P )
--	------------------------

Electrical floor heating with transformer	O (only with Truma P )
---	------------------------

## L. GAS

Gas bottle holder	X
-------------------	---

Gas bottle compartment 2 x 11 kg	1 x 11kg
----------------------------------	----------

## L. GAS

Gas regulation valve	X
Smart box one	O
Smart box two	O

## M. AUDIO/VIDEO

Bluetooth amplifier	O
Loudspeakers with preinstallation for bluetooth transmitter	X
TV holder	O